

**Section 480-A Real Property Tax Law
Management Plan**

Application Number: 8-127

Property Owner:

*Fred May Jr.
417 Porter St.
Easton, Pennsylvania 18042*

Property Location:

Cookhouse Road
Town of Plymouth
Chenango County, New York

March 2014

Prepared By:

Forecon, Inc.
22 ½ Groton Ave.
Cortland, NY 13045
(607) 753-3113

FORECON INC.

Brad Wentworth – Forester Technician

Introduction

This forest Management Plan complies with the rules and regulation under Section 480a of the New York State Real Property Tax Law.

This Five Year Update Report is being submitted by Fred May Jr., an individual with residence at 417 Porter St., Easton, Pennsylvania 18042 .

General Observations

This is a periodic management plan conducted every five years for the 211.8 acre parcel located on Cookhouse Rd. in the Town of Plymouth, Chenango County, New York, which is enrolled into the New York State 480-A tax exemption law. The field work for this update was completed on March 24th and 25th, 2014.

Inventory was collected in stands 2, 3, 9 and 10. More details about these stands can be seen below under stand descriptions. All other stands were inspected for general health and vigor. Since the last update stands 2, 3, 8, 9 and 10 have had management work performed within them. It was observed that the 13 acre block of timber stand improvement within stand 8 has been started but remains incomplete. This TSI should be finished immediately to avoid penalty. It was also noted that hardwood regeneration (mostly white ash, some sugar maple) is coming along in stand 5.

The boundary lines are denoted by orange three stripe paint marks which were refreshed during the update. To ensure the visibility of these property lines, they should be repainted at every subsequent update.

Stand Descriptions

Stand 2

Acres: 34

Forest Type: Hemlock / Northern Hardwoods

Diameter Class: Sawtimber

Acceptable Growing Stock: 74%

Basal Area: 112 sq. ft.

Species Comp. (#trees): EH 51, BIR 18, RM 12, ASP 4, WA 6, OTH 9

Treatment: No Treatment Required.

Comments: This stand was harvested in 2011 and the residual hemlock trees are well spaced. This stand is poorly drained and very little regeneration has occurred except for scattered pockets of white ash and aspen.

Stand 3

Acres: 13

Forest Type: Northern Hardwoods

Diameter Class: Sawtimber

Acceptable Growing Stock: 73%

Basal Area: 80 sq. ft.

Species Comp. (#trees): EH 45, SM 13, BIR 12, WA 12, RM 5, BE 5, OTH 8

Treatment: No Treatment Required.

Comments: This stand was harvested in 2011 and much of the undesirable growing stock was removed during the thinning. There are scattered pockets of hardwood regeneration on the higher spots within the stand.

Stand 9

Acres: 68

Forest Type: Northern Hardwoods

Diameter Class: Sawtimber

Acceptable Growing Stock: 71 %

Basal Area: 68 sq. ft.

Species Comp. (#trees): SM 50, WA 13, RM 12, BIR 9, BC 6, BASS 4, BE 4, EH 2

Treatment: No Treatment Required

Comments: This stand was harvested in 2012 to salvage value from white ash and fire damaged sugar maple. The stand is currently well stocked and the openings in the canopy should promote further regeneration of desirable species such as sugar maple and black cherry.

Stand 10

Acres: 32

Forest Type: Northern Hardwoods

Diameter Class: Sawtimber

Acceptable Growing Stock: 66 %

Basal Area: 73 sq. ft.

Species Comp. (#trees): SM 36, RM 20, BE 16, UGS 9, WA 7, BIR 5, BC 5, BASS 2

Treatment: No Treatment Required

Comments: This stand was harvested in conjunction with stand 9 in 2012. Residual sugar maple and red maple have healthy crowns and good form. This harvest also eliminated a high percentage of beech from the stand which will increase chances of regeneration moving forward.

15-Year Work Schedule

2014-2015	Finish cutting TSI stand 8 (approx. 5-6acres)
2015-2016	No Treatment
2016-2017	No Treatment
2017-2018	No Treatment
2018-2019	No Treatment
2019-2020	5 Year Update, Repaint boundary lines
2020-2021	No Treatment
2021-2022	No Treatment
2022-2023	No Treatment
2023-2024	No Treatment
2024-2025	5 Year Update, Repaint boundary lines
2025-2026	No Treatment
2026-2027	No Treatment
2027-2028	No Treatment
2028-2029	No Treatment
2029-2030	5 Year Update, Repaint boundary lines

NEW YORK STATE DEPARTMENT OF ENVIRONMENTAL CONSERVATION
FOREST LAND CLASSIFICATION AND TREATMENT REPORT

Application Number 8-127	Owner Fred E. May JR	Classified By FORECON INC	Date Mar-14
Owner's Address 417 Porter St.		Department Use Only	
City Easton	State PA	Zip Code 18042	Date
		Checked By	

The lands described in the owner's application for certificate of approval as eligible forest land have been examined and classified below. The stand treatments listed are required practices for continuing eligibility under Section 480-A of the Real Property Tax law.

Stand No.	Acreage	Forest Type	Diameter Class	Site	Basal Area	No. Trees/ Ac.	ELIGIBLE ACREAGE		Year(s)
							Species Composition Percent (nearest 10%)	Silvicultural Treatment	
1	6	PH	PT	II	68	495	ASP 50, SM 12, RM 10, WA 9 OTH 11	No Treatment Required	XXX
2	34	HEM/ NH	ST	III	112	184	EH 51, BIR 18, RM 12, ASP 4, WA 6, OTH 9	No Treatment Required	XXX
3	13	NH	ST	I	80	107	EH 45, SM 13, BIR 12, WA 12, RM 5, BE 5, OTH 8	No Treatment Required	XXX
3A	6	NH	PT	I	110	187	SM 45, WA 33, RM 18, Bass 4	No Treatment Required	XXX
4	8	NS	PT	II	123	251	NS 100	No Treatment Required	XXX
4A	7	WS	PT	II	143	1420	WS 84, RM 7, ASP 7, WA 2	No Treatment Required	XXX
5	4	RP	ST	II	133	292	RP 98, WA 2	No Treatment Required	XXX
6	4	TAM	ST	II	120	200	TAM 94, SM 6	No Treatment Required	XXX
7	5	NS	PT	II	93	257	NS 100	No Treatment required	XXX
8	23	NH	PT	I	76	152	WA 37, SM 31, RM 16, BC 16	No Treatment Required	XXX
9	68	NH	ST	I	68	105	SM 50, WA 13, RM 12, BIR 9, BC 6, BASS 4, BE 4, EH 2	No Treatment Required	XXX
10	32	NH	ST	I	73	144	SM 36, RM 20, BE 16, UGS 9, WA 7, BIR 5, BC 5, BASS 2	No Treatment Required	XXX
	210	Total acres eligible							
DESCRIPTION OF INELIGIBLE AND NON-COMMITTED LAND									
Ineligible 1.8 acres surrounding camp									

NEW YORK STATE DEPARTMENT OF ENVIRONMENTAL CONSERVATION
FOREST LAND CLASSIFICATION AND TREATMENT REPORT

--

Fred May Jr. Management Plan

Forest Type Map
Town of Plymouth
Chenango County
New York
March 2014

COOKHOUSE ROAD

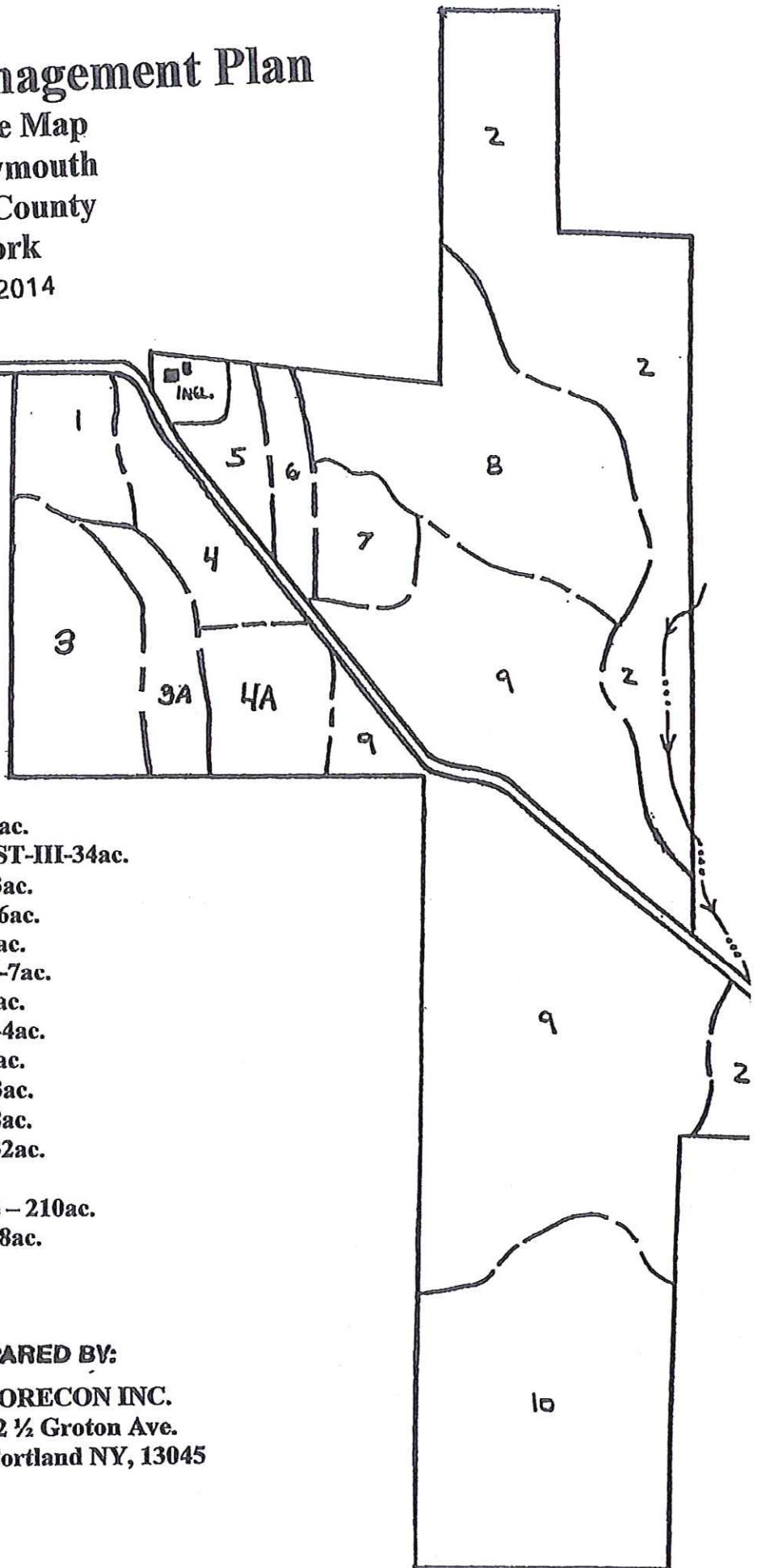

KEY:

- 1 PH-PT-II-6ac.
- 2 HEM/ NH-ST-III-34ac.
- 3 NH-ST-I-13ac.
- 3A NH-PT-I-6ac.
- 4 NS-PT-II-8ac.
- 4A WS-PT-II-7ac.
- 5 RP-ST-II-4ac.
- 6 LAR-ST-II-4ac.
- 7 NS-PT-II-5ac.
- 8 NH-PT-I-23ac.
- 9 NH-ST-I-68ac.
- 10 NH-ST-I-32ac.

Total Eligible – 210ac.
Ineligible – 1.8ac.



SCALE: 1"=660'

OWNER'S ADDRESS:

FRED MAY
417 PORTER ST.
EASTON, PA 18042

PREPARED BY:

FORECON INC.
22 1/2 Groton Ave.
Cortland NY, 13045

APPLICATION # 8-127
CHECKED BY: _____