

Overall Surveyed Area:
86.313 Acres +/-
(calculated to centerline of Township Road)

CURVE DATA TABLE

NUMBER	RADIUS	ARC LENGTH	CHORD DIRECTION	CHORD LENGTH
C1	1151.73'meas.	381.46'meas.	S 04°45'11\" W	379.72'meas.
C2	1087.55'meas.	397.57'meas.	S 16°19'09\" W	395.36'meas.
C3	1481.10'meas.	334.76'meas.	S 30°30'56\" W	334.05'meas.

REFERENCE DEED/
Warranty Deed/
EVP Lumber, Inc.
to
Baldwin's Forest Products, Inc.
Instrument No.2014-69353, Recorded: 06/02/2014
(See Liber: 599 @ Page: 626, part of 1st Parcel, 2nd Tract - 162.5 Acre Lot)

AN ABSTRACT OF TITLE WAS NOT USED IN THE PREPARATION OF THIS INSTRUMENT SURVEY

- **SURVEY NOTES/
1. LANDS ON THIS SURVEY ARE BASED ON THE REFERENCES LISTED AND CONTAINED HEREON.
2. ONLY VISIBLE UTILITY SERVICES AND/OR ENCUMBRANCES WERE LOCATED AND ARE SHOWN.
3. UNAUTHORIZED ALTERATION AND/OR ADDITION TO A SURVEY PLAN THAT BEARS A NEW YORK STATE LICENSED LAND SURVEYOR'S SEAL IS A VIOLATION OF SECTION 7209, SUBDIVISION NO. 2, OF THE NEW YORK STATE EDUCATION LAW.
4. CERTIFICATION
THIS IS TO CERTIFY THAT I AM A NEW YORK STATE LICENSED LAND SURVEYOR AND THAT THIS PLAN WAS COMPLETED FROM THE NOTES OF AN INSTRUMENT SURVEY PERFORMED UNDER MY SUPERVISION.
5. TO BE A VALID REPRODUCTION, COPIES OF THIS SURVEY PLAN MUST BEAR AN ORIGINAL OF THE NEW YORK STATE LICENSED LAND SURVEYOR'S EMBOSSED SEAL. DUPLICATIONS ARE SUBJECT TO TITLE - 17, OF THE U.S. CODE COPYRIGHT STATUTE.

Legend

- d. - denotes a deeded dimension
- m./meas. - denotes a measured dimension
- - denotes a 1/2" rebar w/ cap, set this survey
- - denotes a monument found (as noted)
- ⊙ - denotes a old oil field water well

Surveyor's Note:
Surveyed Parcel is situate, in part or whole, on a portion of an OLD oilfield production property. NO attempt was made to locate ANY oilfield apparatus -i.e. wells, tanks, powerhouses, surface or sub-surface pipelines, etc. -if any exist on premises.

THIS PLAN NOT VALID WITH "AFFIDAVIT OF NO CHANGE"
PLAN OF A SURVEY OF LANDS PREPARED FOR/ BALDWIN'S FOREST PRODUCTS, INC.

GREAT LOT No. 12+13	TOWNSHIP No. 1	RANGE No. 1
LAND TRACT HOLLAND LAND CO.		
TOWN OF BOLIVAR		
TAX MAP NO. 287.00-1-8.4		
COUNTY OF ALLEGANY		
STATE OF NEW YORK		
DATE OF SURVEY: 01/04/12/2016		
DATE OF PLAN: 01/12/2016		
JOB NO. 4410		

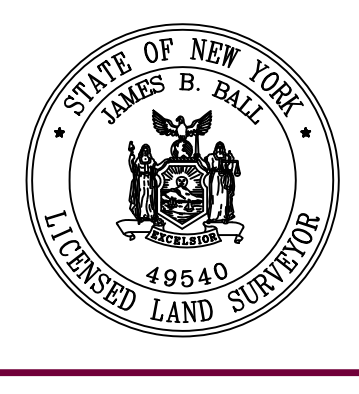

JAMES BALL
LAND SURVEYOR
James Ball (585) 593-4691
Wellsville New York

James B. Ball
JAMES B. BALL
LICENSE NO. 49540
ONLY PRINTS OF THIS SURVEY PLAN THAT BEAR AN ORIGINAL OF MY EMBOSSED SEAL SHALL BE CONSIDERED A VALID COPY.

T:\JOBS\Y16\4410 REVISIONS DATE